

Mopar Gate Plate Installation



1. Removing the gate can be done in the vehicle, but installation would be easier if shifter is removed from vehicle.
2. Remove the T-Handle decal from the shifter.
3. Remove screw and then pull up the T-Handle, Fig. 1.
4. Remove lift mechanism spring, Fig. 2 .
5. Remove roll pin that retains the lift mechanism (1/8" punch), Fig. 3.
6. Slide the lift mechanism off of the shaft, Fig. 4.
7. Loosen the passenger's side spacer bolts with a 5/16" socket. Remove the two driver's side spacer bolts with a 5/16" socket, Fig. 5.
8. Remove the driver's side shaft bolt with 7/16" socket. You must hold the passenger's side shaft bolt when removing the driver's bolt (air wrench would work best.), Fig. 6 & 7.
9. Place shifter handle in **Third** if Stock Pattern or **First** if Reverse Pattern. Spread shifter housing, Fig. 8.
10. Pull gate out and up, Fig. 9.
11. Install new gate. Be sure that the **Park** position is towards the dash of the car. Push the two halves together and use a rubber hammer to tap gate into place, Fig. 10.
12. Install the side center housing bolt, but **do not** tighten. Line up spacer bolt holes with punch and install bolts. Squeeze the plates together and tighten the four spacer bolts. Be careful **not** to over tighten. Tighten the side bolts. **Do not use air tool to tighten**, Fig. 11 & 12.
13. Put lever in the **Park** position and carefully install the lift mechanism and roll pin into place, Fig. 13.
14. Install lift mechanism spring, Fig. 2.
15. Install T-Handle. Use Loctite on the screw, but **do not** over tighten, Fig. 1.
16. Install T-Handle decal.
17. Gate identification, Fig. 14.





Fig. 1



Fig. 2



Fig. 3



Fig. 4



Fig. 5



Fig. 6



Fig. 7



Fig. 8





Fig. 9



Fig. 10



Fig. 11



Fig. 12



Fig. 13

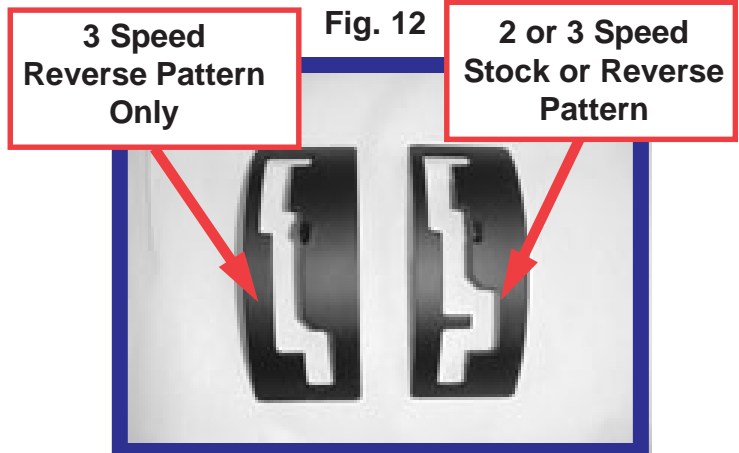
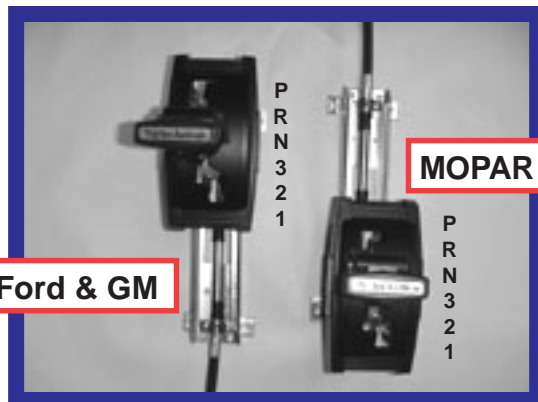

Fig. 14



Ford & GM

MOPAR

Park Location to Cable



1535 Owens Road
Jacksonville, Florida 32218
Phone 904-741-4850
www.turboaction.com



Fig. #7
ControlSwitch Kit - #70205
and
T-Handle Kit - #70061

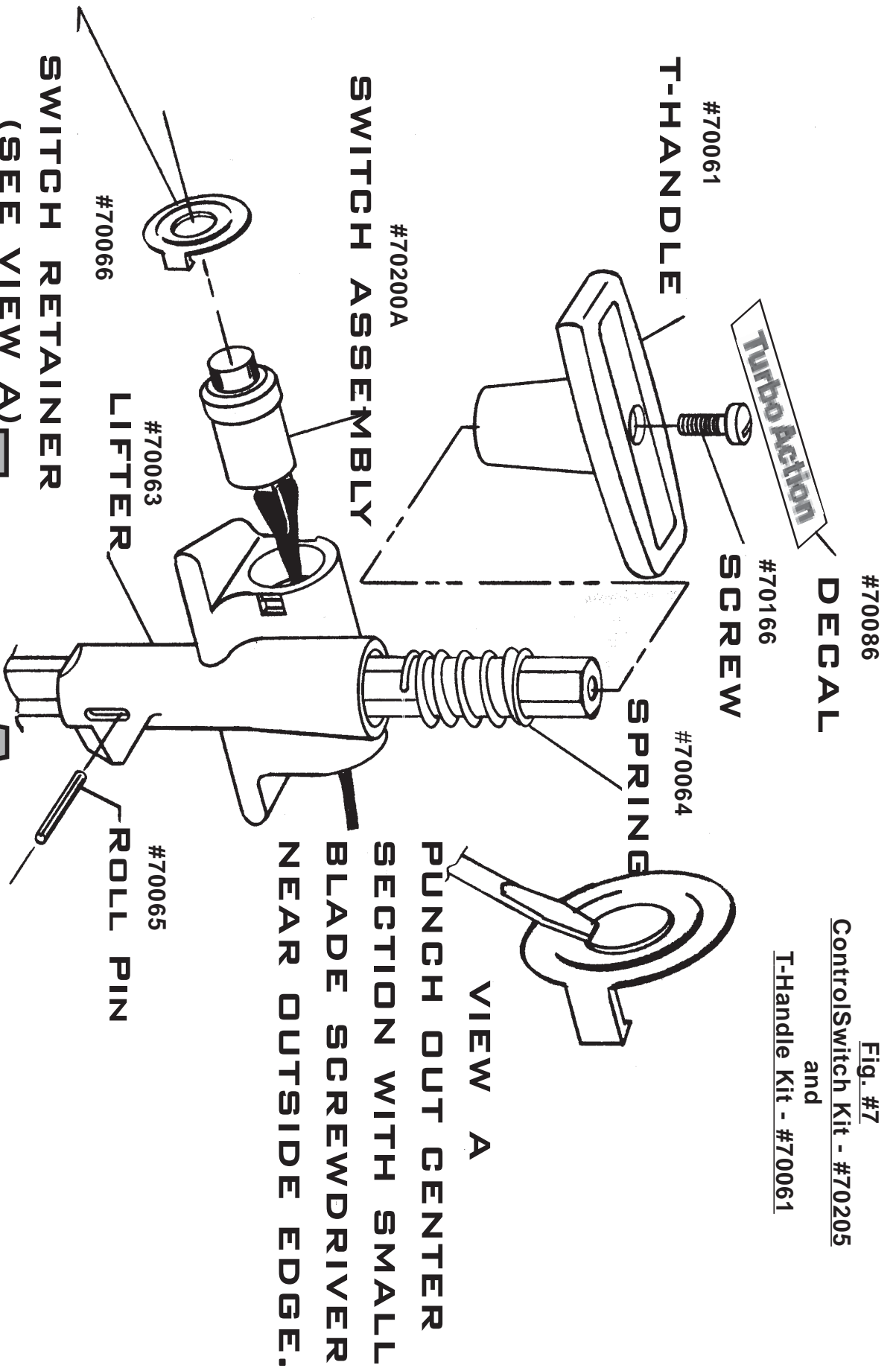

TURBO ACTION

1535 Owens Road, Jacksonville, FL
32218 (904)741-4850
FAX (904)741-4853

**Installation Kit
#70220**

U-Clamp must fit over groove in steel jacket on the cable.

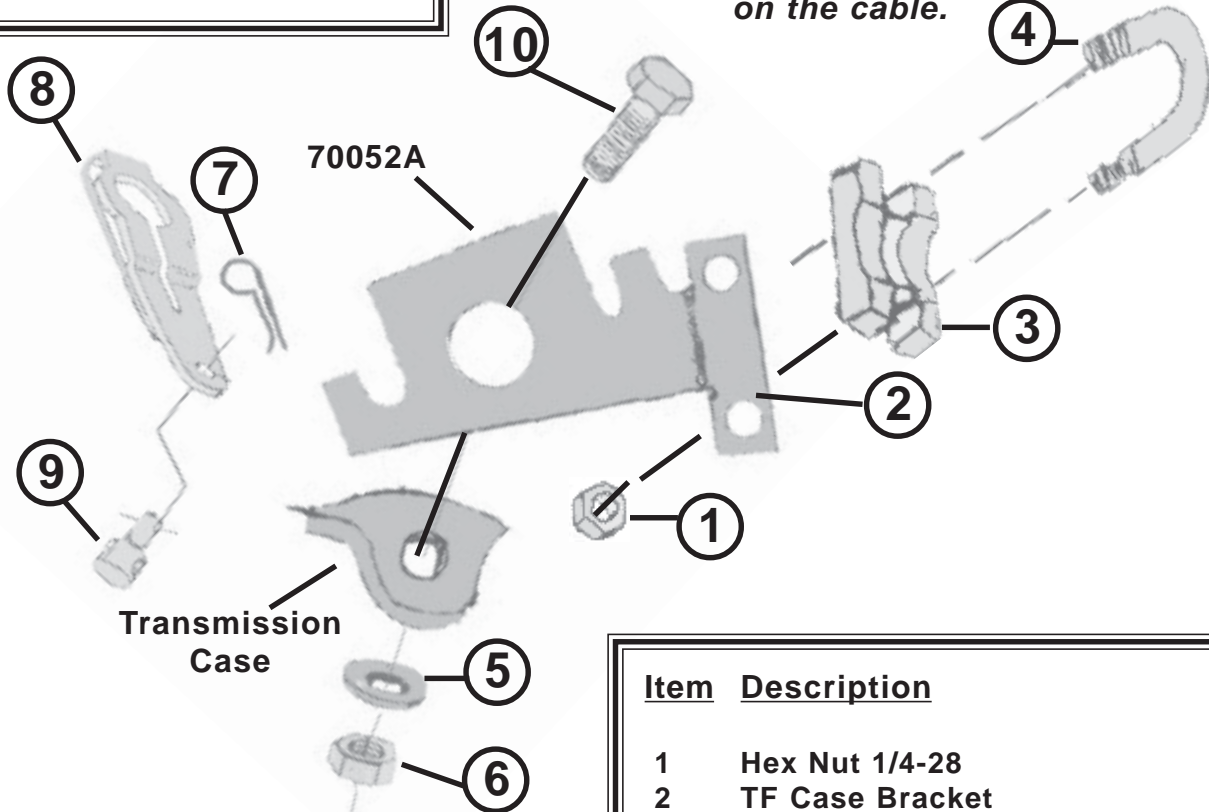

Item	Description	Qty.
1	Hex Nut 1/4-28	2
2	TF Case Bracket	1
3	Shim Block	1
4	Cable U-Clamp	1
5	Lock Washer 1/2	1
6	Hex Nut 1/2-13	1
7	Hairspring Cotter	1
8	TF Shift Lever	1
9	Pivot	1
10	Hex Head Bolt 1/2-13 x 1 1/4	1

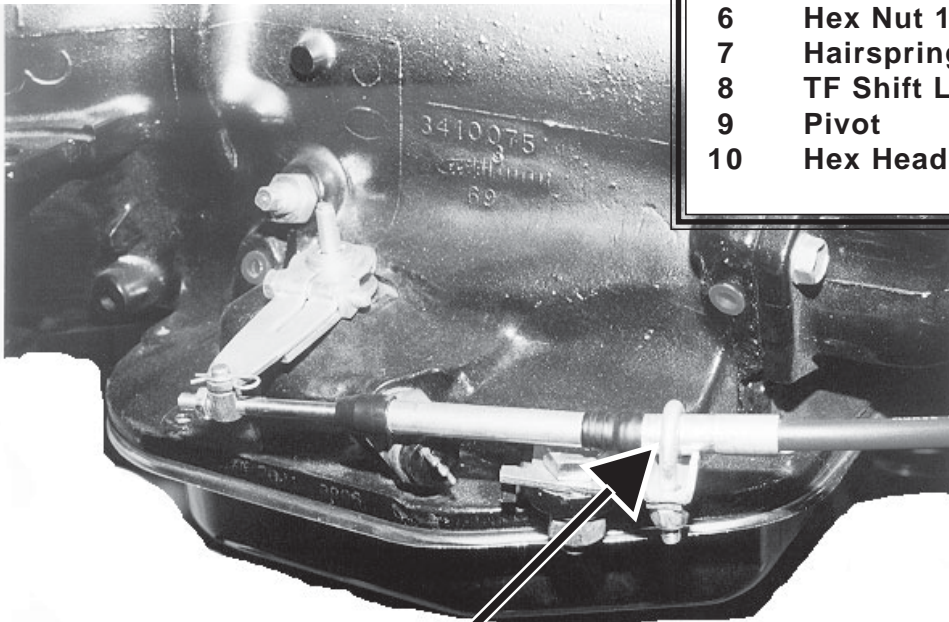

Note: U-Clamp must fit over groove in steel jacket on the cable.

TURBO ACTION

1535 Owens Road, Jacksonville, FL 32218
Phone 904-741-4850 *** FAX 904-741-4853

www.turboaction.com



Valve Bodies

Powerglide
Turbo 200*, 350*, 400
Torqueflite 404, A500, A518, 727*/904*
Torque-Command 727*/904*
Ford C4, C6

**Available as Electronic Valve Bodies*

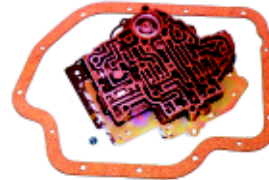
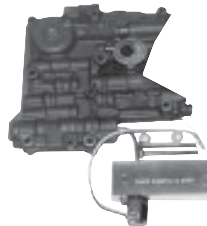
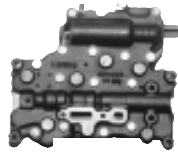

Torque Converters (8", 9", 10", 11")

Torqueflite 404, A500, A518, 727, 904
Powerglide
Turbo 200, 350, 400
Ford C4, C6



Valve Body Kits

Torqueflite A500, A518, 727/904
Powerglide
Turbo 200, 350, 400
Ford C4, C6

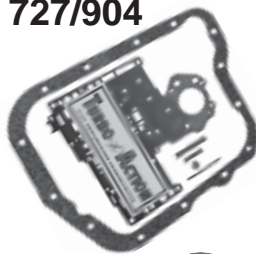

Tranz Boxes

Torqueflite 727, 904
Powerglide
Turbo 350, 400



Special Items

727 Rear Support w/Bearing



**CHEETAH
E-Shift Controller**
(Electronic Shift Control Box)



Cheetah SCS Shifters

Powerglide, Turbo 200, 350, 400
Torqueflite 727/904
Ford C4/C6



SFI Torqueflite Flexplates



Transmissions

Torqueflite 727, 904
Powerglide
Turbo 200, 350, 400
Ford C4, C6



Cover



Command Center

