

# Ford & GM Gate Plate Installation



**Caution:**

**Ford & GM do not use the same gate plates!  
Only the instructions are the same.**



1. Removing the gate can be done in the vehicle, but installation would be easier if shifter is removed from vehicle.
2. Remove the T-Handle decal from the shifter.
3. Remove the screw and then pull up the T-Handle, Fig. 1.
4. Remove lift mechanism spring, Fig. 2 .
5. Remove roll pin that retains the lift mechanism (1/8" punch), Fig. 3.
6. Slide the lift mechanism off of the shaft, Fig. 4.
7. Loosen the passenger's side spacer bolts with a 5/16" socket. Remove the two driver's side spacer bolts with a 5/16" socket, Fig. 5.
8. Remove the driver's side shaft bolt with 7/16" socket. You must hold the passenger's side shaft bolt when removing the driver's bolt (air wrench would work best.), Fig. 6.
9. Place shifter handle in **Third** if Stock Pattern or **First** if Reverse Pattern. Spread shifter housing, Fig. 7. If Powerglide, See Fig. #13.
10. Pull gate out and up, Fig. 8.
11. Install new gate. Be sure that the **Park** position is towards the dash of the car. Push the two halves together and use a rubber hammer to tap gate into place, Fig. 9.
12. Install the side center housing bolt, but **do not** tighten. Line up spacer bolt holes with punch and install bolts. Squeeze the plates together and tighten the four spacer bolts. Be careful **not** to over tighten. Tighten the side bolts. **Do not use air tool to tighten**, Fig. 10 & 11.
13. Put lever in the **Park** position & carefully install the lift mechanism and roll pin into place, Fig.12.
14. Install lift mechanism spring, Fig. 2.
15. Install T-Handle. Use Loctite on the screw, but **do not** over tighten, Fig. 1.
16. Install T-Handle decal.
17. Gate identification, Fig. 13.





Fig. 1



Fig. 2



Fig. 3



Fig. 4



Fig. 5



Fig. 6



Fig. 7

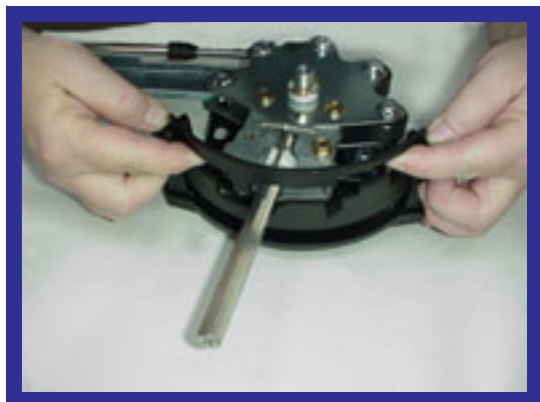

Fig. 8





Fig. 9



Fig. 10



Fig. 11



Fig. 12

3 Speed  
Reverse Pattern  
Only

2 or 3 Speed  
Stock or Reverse  
Pattern

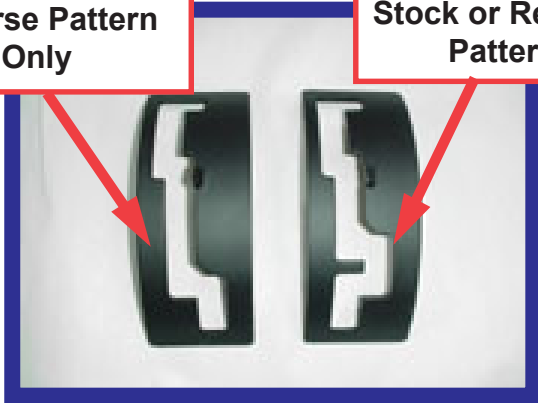

Fig. 13



Ford & GM

MOPAR

Park Location to Cable

This space  
Not Used on  
Powerglide.  
Plastic Block  
Plate available  
#70060.

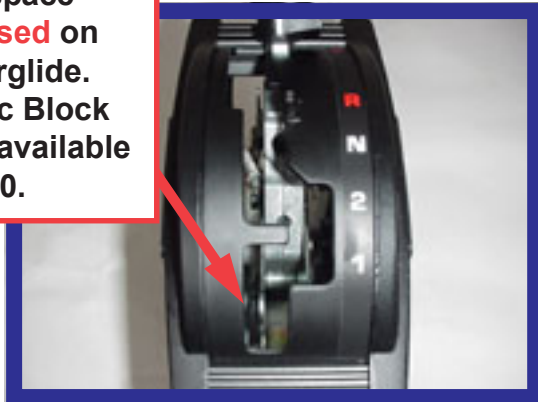

Powerglide Gate Location

**NOTE: Spring action is to the right on all shifter models.**



1535 Owens Road  
Jacksonville, Florida 32218  
Phone 904-741-4850  
www.turboaction.com



#70086

**DECAL**

#70166

**SCREW**

#70061

**T-HANDLE**

#70064

**SPRING**

#70200A

**SWITCH ASSEMBLY**

#70063

**LIFTER**

#70066

**SWITCH RETAINER  
(SEE VIEW A)**

#70065

**ROLL PIN**

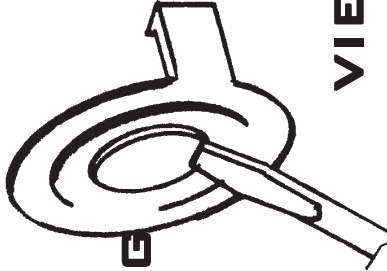

**VIEW A**

**PUNCH OUT CENTER SECTION WITH SMALL BLADE SCREWDRIVER NEAR OUTSIDE EDGE.**

ControlSwitch Kit - #70205  
and  
T-Handle Kit - #70061



**TURBO ACTION**

1535 Owens Road, Jacksonville, FL  
32218 (904)741-4850  
FAX (904)741-4853

# G.M. PAN CABLE BRACKET

## CHEETAH SCS SHIFTER

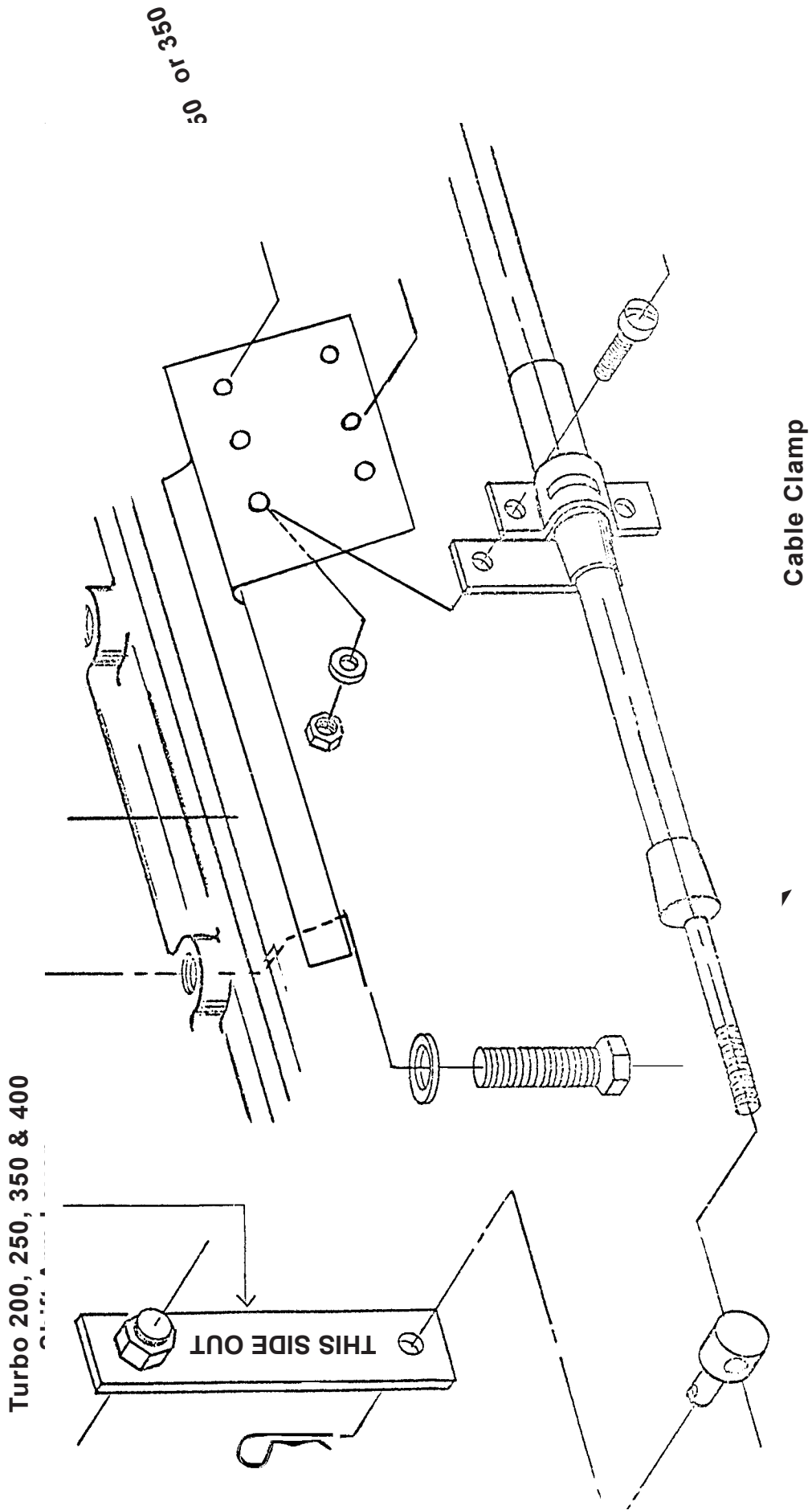

Part #70050A/#70075B

6/09/07

**G.M. Pan Cable Bracket Location**  
**for Type of Transmission**

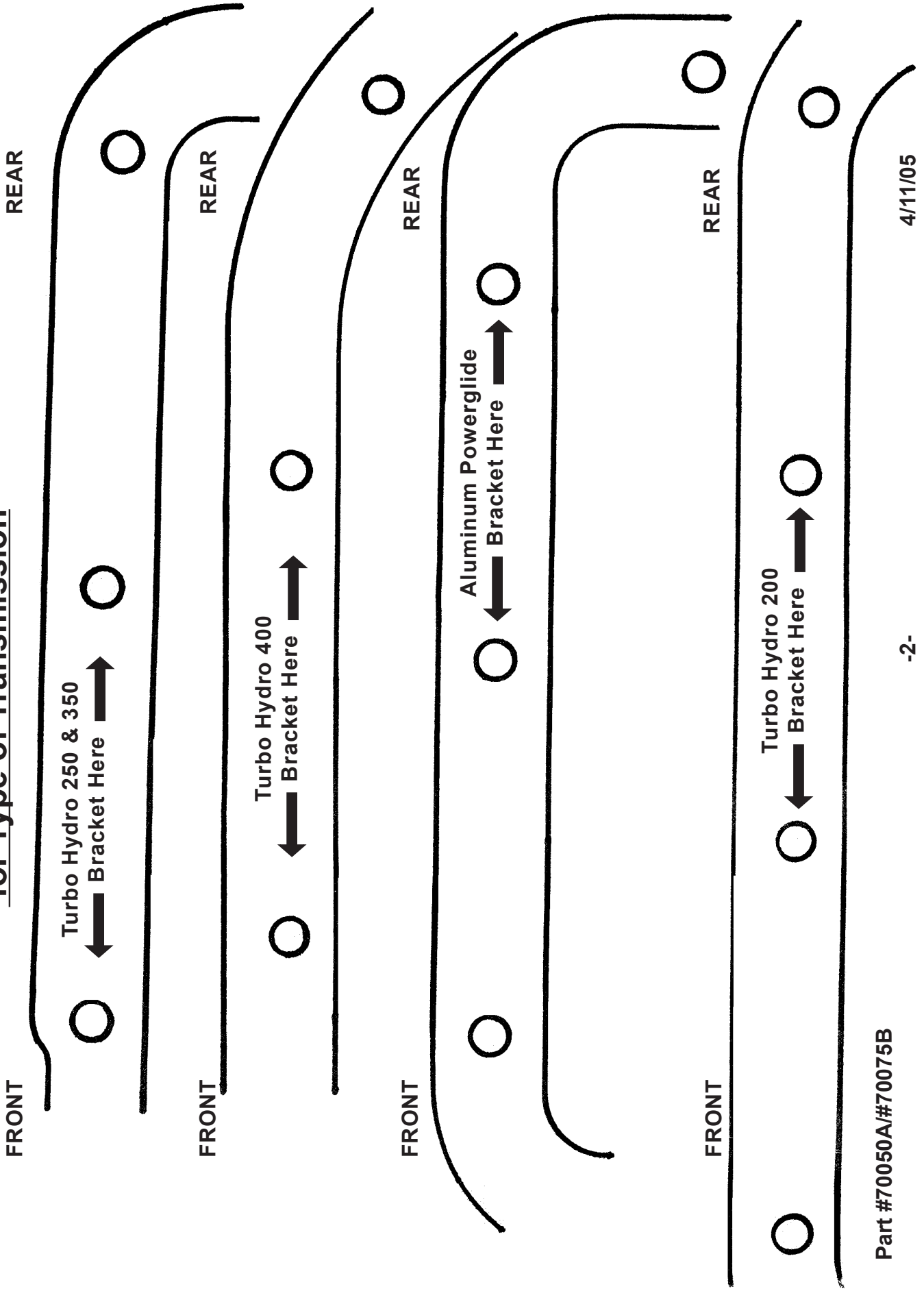



# TURBO ACTION

1535 Owens Road, Jacksonville, FL 32218  
Phone 904-741-4850 \*\*\* FAX 904-741-4853

[www.turboaction.com](http://www.turboaction.com)



## Valve Bodies

Powerglide  
Turbo 200\*, 350\*, 400  
Torqueflite 404, A500, A518, 727\*/904\*  
Torque-Command 727\*/904\*  
Ford C4, C6

*\*Available as Electronic Valve Bodies*

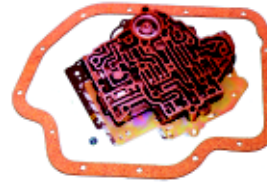
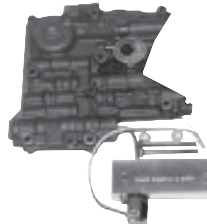

## Torque Converters (8", 9", 10", 11")

Torqueflite 404, A500, A518, 727, 904  
Powerglide  
Turbo 200, 350, 400  
Ford C4, C6



## Valve Body Kits

Torqueflite A500, A518, 727/904  
Powerglide  
Turbo 200, 350, 400  
Ford C4, C6

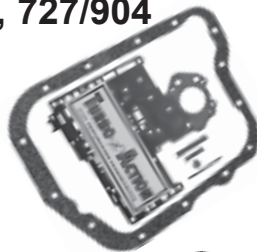

## Tranz Boxes

Torqueflite 727, 904  
Powerglide  
Turbo 350, 400



## Special Items

727 Rear Support w/Bearing



CHEETAH  
E-Shift Controller  
(Electronic Shift Control Box)

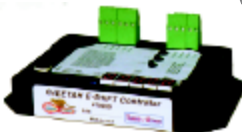

## Cheetah SCS Shifters

Powerglide, Turbo 200, 350, 400  
Torqueflite 727/904  
Ford C4/C6



## SFI Torqueflite Flexplates



## Transmissions

Torqueflite 727, 904  
Powerglide  
Turbo 200, 350, 400  
Ford C4, C6



## Cover



## Command Center



